



RIVET SHELVING

Everything that you need for your SMART STORAGE

RIVET SHELVING is a system that has highly escalated and positioned itself in the market as one of the most in demand storage furniture options due to it's versatility, customizable sizes, storage capacity and easy assembly making it a perfect option for warehouse, residential and office applications.



FEATURES & ADVANTAGES

- ✓ Boltless, clipless construction for an easy assembly.
- ✓ Open design with a wide span capability of 96 inches.
- ✓ Great powder-coated finish that prevents corrosion.

- ✓ Versatile system that allows adjustable levels easily and addition of more levels positions if necessary.
- ✓ Customizable you can combine our sizes and capacities (double rivet or single rivet beam) to meet specific storage requirements.

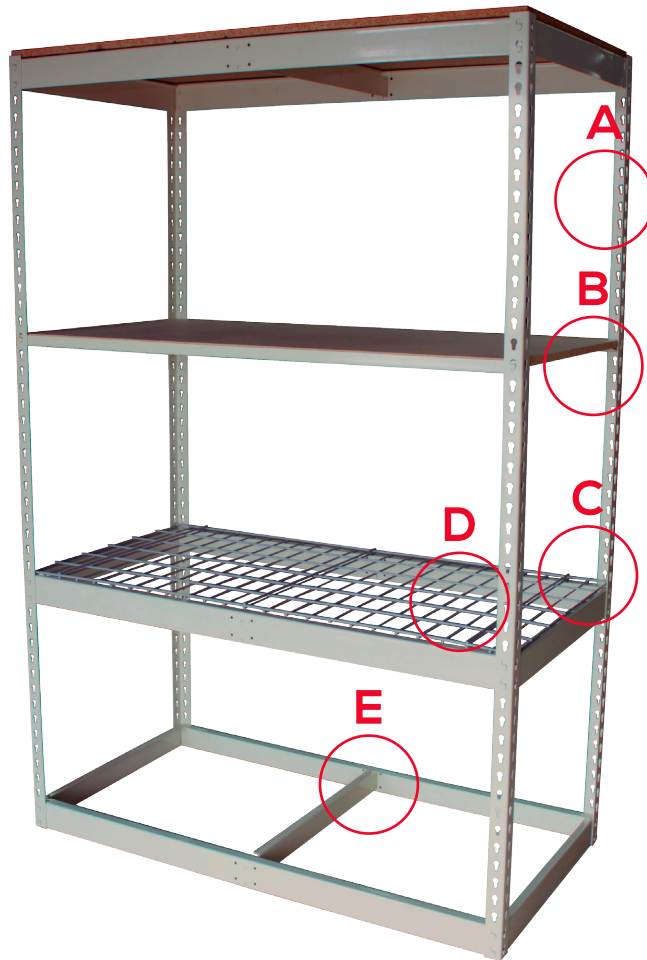

A
POWDER COAT FINISH



B
SINGLE RIVET



C
DOUBLE RIVET

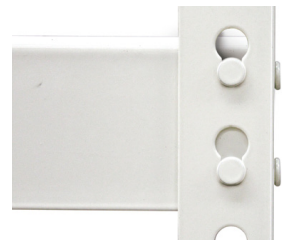

D
DECKING OPTIONS

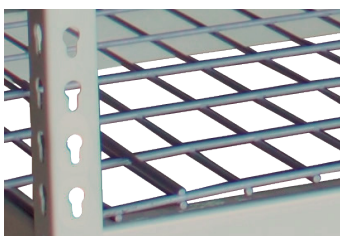

E
CENTER SUPPORTS



DOUBLE RIVET

- ✓ Designed for handling larger volume items both efficiently and economically.
- ✓ Sections can be as large as 96" wide minimizing the number of post obstructions and accommodating an array of load sizes within the same unit.
- ✓ Depth can be great as 48".
- ✓ Sections 72" ,60" or 48" long, require one center support per level.
- ✓ Sections 96" long require two center support per level.



CAPACITY CHART (Lbs)

| DOUBLE RIVET BEAM | | | | | |
|------------------------|-----------|-------------------|---------------------|-----------|-------------------|
| WITHOUT CENTER SUPPORT | | | WITH CENTER SUPPORT | | |
| W" x D" | SHELF CAP | MAX UNIT CAPACITY | W" x D" | SHELF CAP | MAX UNIT CAPACITY |
| 48 x 12 | 320 | 2300 | 48 x 12 | 1400 | 2300 |
| 48 x 18 | 320 | 2300 | 48 x 18 | 1400 | 2300 |
| 48 x 24 | 320 | 2300 | 48 x 24 | 1400 | 2300 |
| 48 x 36 | 320 | 2300 | 48 x 36 | 1200 | 2300 |
| 48 x 48 | 320 | 2300 | 48 x 48 | 1125 | 2300 |
| 60 x 18 | 250 | 2300 | 60 x 18 | 1200 | 2300 |
| 60 x 24 | 250 | 2300 | 60 x 24 | 1200 | 2300 |
| 60 x 36 | 250 | 2300 | 60 x 36 | 1200 | 2300 |
| 60 x 48 | 250 | 2300 | 60 x 48 | 1200 | 2300 |
| 72 x 18 | 210 | 2300 | 72 x 18 | 1000 | 2300 |
| 72 x 24 | 210 | 2300 | 72 x 24 | 1000 | 2300 |
| 72 x 36 | 210 | 2300 | 72 x 36 | 1000 | 2300 |
| 96 x 18 | 620 | 2300 | 72 x 48 | 1000 | 2300 |
| 96 x 24 | 620 | 2300 | 96 x 18 | 1400 | 2300 |
| 96 x 36 | 620 | 2300 | 96 x 24 | 1400 | 2300 |
| 96 x 48 | 620 | 2300 | 96 x 36 | 1400 | 2300 |
| | | | 96 x 48 | 1400 | 2300 |

EXAMPLE OF SECTION GROWTH

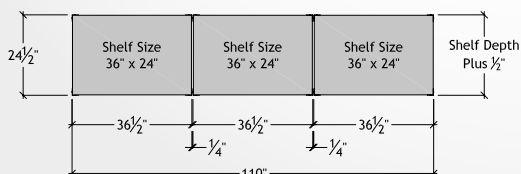
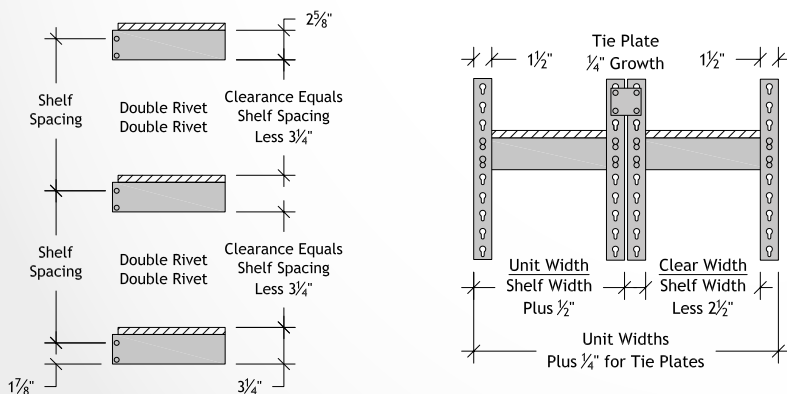

DOUBLE RIVET BEAM

| in | mm | in | mm |
|-----|-----|--------|------|
| 12" | 305 | 42" | 1067 |
| 15" | 381 | 48" | 1220 |
| 18" | 457 | 60" | 1524 |
| 24" | 610 | 72" | 1829 |
| 30" | 762 | 96" | 2438 |
| 36" | 914 | 96" CH | 2438 |

Standard 96" Long Beams have a Channel Design Additional Sizes Available Upon Request



Shelf levels are adjustable on 1-1/2" centers.

Sections over 12' high have posts 1-7/8" x 1-7/8".

Easy assembly with only a rubber mallet.

SINGLE RIVET

- ✓ For higher density applications, Single Rivet Shelving offers a more efficient use of storage space.
- ✓ With Single Rivet Beams measuring only 1" thick, they provide the maximum usable clearance possible between shelves.
- ✓ Sections are designed with Double Rivet Beams for the top and bottom levels and use Single Rivet Beams for the intermediate.
- ✓ Since diagonal braces are not required with Rivet Shelving, products can be accessed from all sides of the section.
- ✓ Single Rivet Sections can be as large as 48" long and 48" deep, helping to provide an economic solution to the most complex layouts.
- ✓ For sections 24" deep or smaller, Single Rivet Levels only have beams on the front and back to adequately support the decking.
- ✓ Sections that are greater than 24" deep require beams on all four sides. Shelves are adjustable on 1½" centers and are easily assembled with only a rubber mallet.





SINGLE RIVET BEAM

| in | mm | in | mm |
|-----|-----|-----|------|
| 12" | 305 | 30" | 762 |
| 15" | 381 | 36" | 914 |
| 18" | 457 | 42" | 1067 |
| 24" | 610 | 48" | 1220 |

Additional Sizes Available Upon Request
Sections 24" deep and smaller have
beams on front & back only



Single Rivet sections 10' or higher require
a minimum of 3.

Double Rivet levels for rigidity
(can include top and bottom).

Sections over 12' high have posts 1-7/8" x 1-7/8".

CAPACITY CHART (Lbs)

| SINGLE RIVET BEAM | | |
|------------------------|-----------|-------------------|
| WITHOUT CENTER SUPPORT | | |
| W" x D" | SHELF CAP | MAX UNIT CAPACITY |
| 36 x 12 | 150 | 2300 |
| 36 x 15 | 150 | 2300 |
| 36 x 18 | 150 | 2300 |
| 36 x 24 | 150 | 2300 |
| 42 x 12 | 130 | 2300 |
| 42 x 15 | 130 | 2300 |
| 42 x 18 | 130 | 2300 |
| 42 x 24 | 130 | 2300 |
| 48 x 12 | 110 | 2300 |
| 48 x 15 | 110 | 2300 |
| 48 x 18 | 110 | 2300 |
| 48 x 24 | 110 | 2300 |

EXAMPLE OF SECTION GROWTH

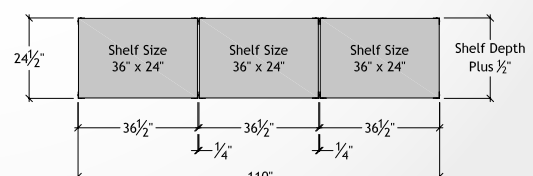
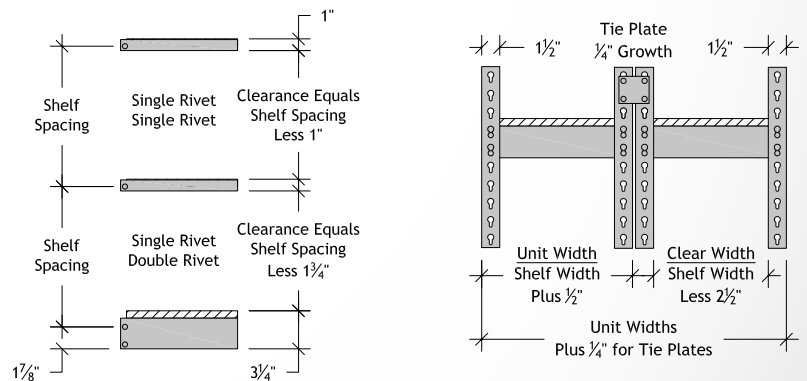



EVERYTHING YOU NEED FOR YOUR SMART STORAGE

Want to save on Storage Space and maximize square footage in your warehouse.
We mobilize Racks, Knock Down, Transport, and assemble your Racks.

CALL US

+1 (704) 610-1100 1 (704) 498-6263

- ✓ Selective Pallet Rack
- ✓ Cantilever Racks
- ✓ Lockers
- ✓ Mezzanines
- ✓ Steel Shelving
- ✓ Rivet Shelving
- ✓ Pallet Jacks
- ✓ Wire Deck

www.mecarackusa.com sales@mecarackusa.com

